

CONSTRUCTION OF ANCHOR FOR
TRENCH E/SLOPING SIDE WALLS

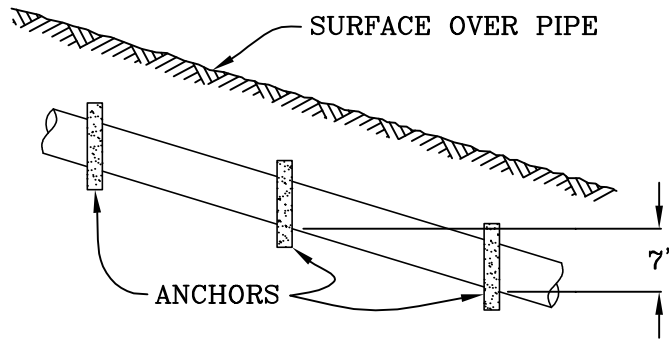
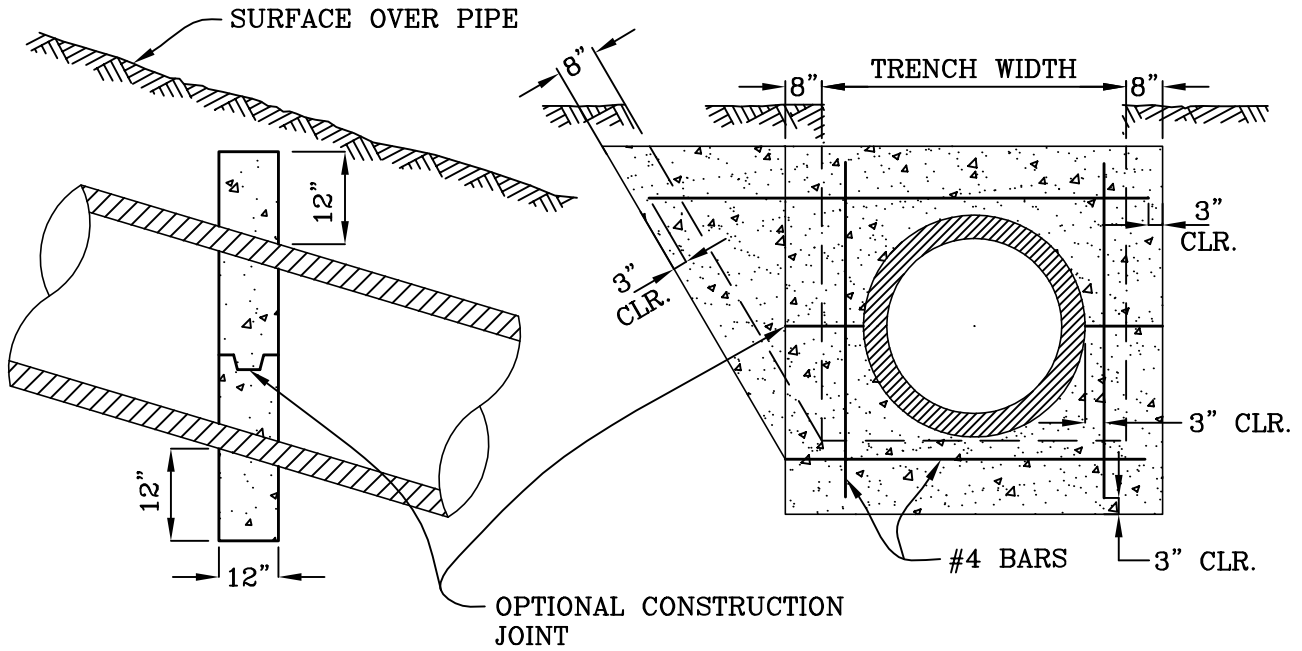

NOTES:

1. PIPE ANCHORS SHALL BE CONSTRUCTED AT 7' VERTICAL INTERVALS ON ALL SLOPES OF 5:1 OR STEEPER.
2. ALL REINFORCING STEEL SHALL BE #4 BARS.
3. CONCRETE SHALL BE CLASS 500-C-2500 CONCRETE.

CITY OF MISSION VIEJO

CONCRETE PIPE SLOPE ANCHOR

STANDARD
PLAN NO.

424



Robert Anderson

9-23-03

APPROVED

RCE 30190

DATE

SHT 1 OF 1